

LEVEL 2 MEETING SPACE

STUDENT UNION BLVD

UNIVERSITY BLVD

WESBROOK MALL

UNIVERSITY PLAZA

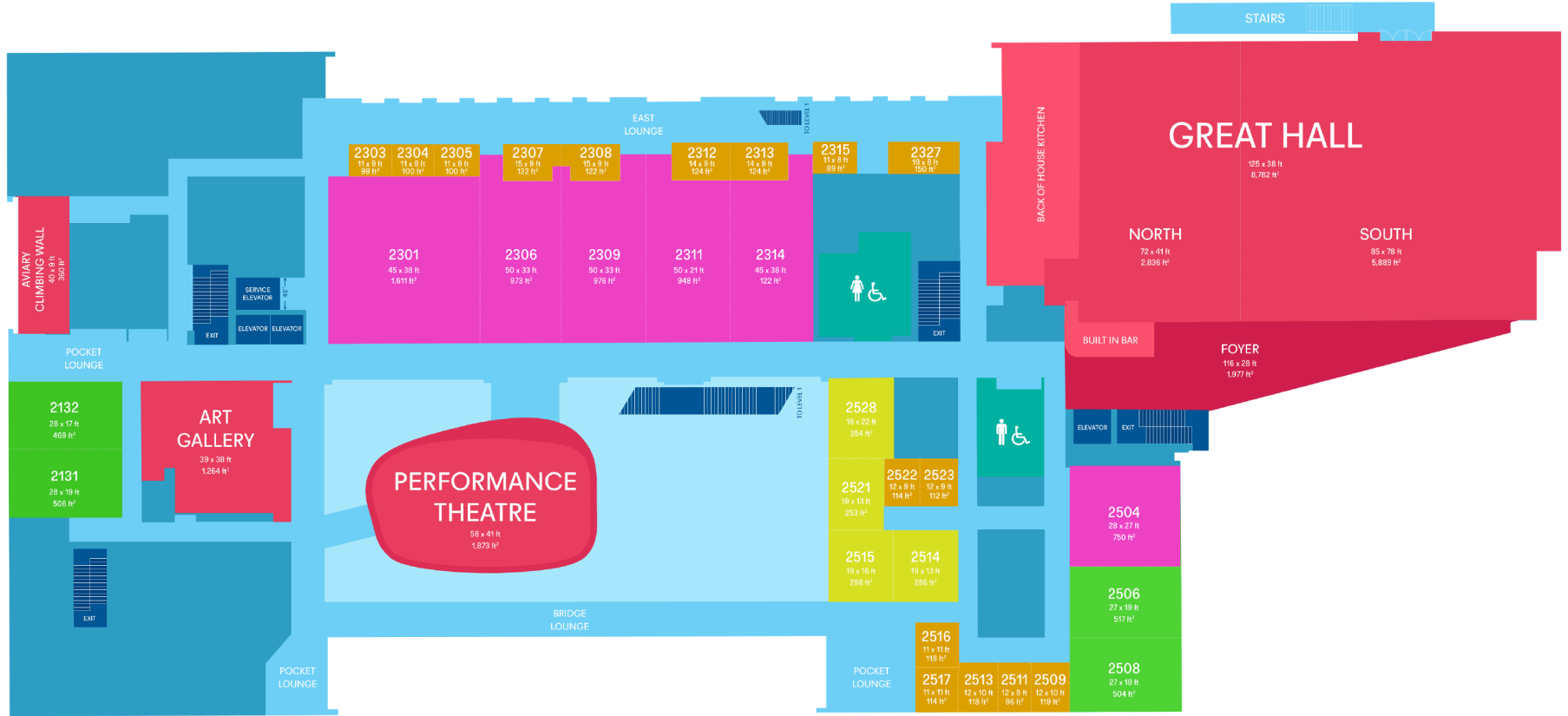

- UNIQUE VENUE
- SMALL ROOM
- MEDIUM ROOM
- LARGE ROOM
- BOARDROOM



LEVEL 2 MEETING SPACE

The **NEST** at the University of British Columbia
amscc.ca @thenestubc

MEETING ROOMS	BOOTH CAPACITIES	CAPACITIES* (MAXIMUM)						DIMENSIONS		CEILING HEIGHT
		THEATRE	CLASSROOM	BANQUET	RECEPTION	U-SHAPE	BOARDROOM	FEET	FT²	
								FEET	FEET	
GREAT HALL	53	859	504	600	1020	-	-	125 X 78	8,782	22'
GREAT HALL SOUTH	32	555	288	350	684	-	-	85 X 78	5,889	22'
GREAT HALL NORTH	17	240	144	150	329	-	-	72 X 41	2,836	22'
GREAT HALL FOYER	-	-	-	-	105	-	-	116 X 28	1,977	22'
PERFORMANCE THEATRE	-	136	63	80	218	38	-	58 X 41	1,873	10'
ART GALLERY	-	88	63	50	147	35	-	39 X 38	1,264	12'
ROOM 2301	-	144	90	120	187	41	-	45 X 38	1,611	10'
ROOM 2306/2309	-	180	105	120	226	41	-	55 X 44	1,949	10'
ROOM 2306	-	80	45	60	113	23	-	50 X 22	973	10'
ROOM 2309	-	80	45	60	113	23	-	50 X 22	976	10'
ROOM 2311	-	80	45	60	110	23	-	50 X 22	948	10'
ROOM 2314	-	80	45	60	109	23	-	50 X 21	941	10'
ROOM 2504	-	60	36	40	87	26	-	28 X 27	750	10'
ROOM 2506	-	52	27	30	60	20	-	27 X 19	517	10'
ROOM 2508	-	42	21	20	59	17	-	27 X 19	504	10'
ROOM 2131	-	51	24	30	59	14	-	29 X 19	506	10'
ROOM 2132	-	45	18	30	54	20	-	28 X 17	469	10'
ROOM 2514	-	23	12	10	33	14	-	19 X 16	286	10'
ROOM 2515	-	21	6	10	35	11	-	19 X 16	298	10'
ROOM 2521	-	16	12	10	29	11	-	19 X 13	253	10'
ROOM 2528	-	24	18	20	41	11	-	16 X 22	354	10'
ROOM 2307	-	-	-	-	-	-	8	15 X 9	122	15'
ROOM 2308	-	-	-	-	-	-	8	15 X 9	122	15'
ROOM 2312	-	-	-	-	-	-	8	14 X 9	124	15'
ROOM 2313	-	-	-	-	-	-	8	14 X 9	124	15'
ROOM 2327	-	-	-	-	-	-	8	19 X 8	150	15'
ROOM 2509	-	-	-	-	-	-	8	12 X 10	119	10'
ROOM 2511	-	-	-	-	-	-	8	12 X 8	96	10'
ROOM 2513	-	-	-	-	-	-	8	12 X 10	118	10'
ROOM 2516	-	-	-	-	-	-	8	11 X 11	118	10'
ROOM 2517	-	-	-	-	-	-	8	11 X 11	114	10'
ROOM 2522	-	-	-	-	-	-	8	12 X 9	114	10'
ROOM 2523	-	-	-	-	-	-	8	12 X 9	112	10'
ROOM 2303	-	-	-	-	-	-	6	11 X 9	99	15'
ROOM 2304	-	-	-	-	-	-	6	11 X 9	100	15'
ROOM 2305	-	-	-	-	-	-	6	11 X 9	100	15'
ROOM 2315	-	-	-	-	-	-	4	11 X 8	89	15'



Great Hall

A multipurpose venue that can be tailored to a wide range of events, great or small. The hall is equipped with a skywall that divides the space for smaller functions, and four state-of-the-art projector screens fit for presentations, screenings and slide shows, plus a built-in sound system that plays up the room's existing acoustics. Floor-to-ceiling windows wrap around the east and south edges of the ballroom. The Great Hall is the perfect space to host tradeshows, general and breakout sessions, corporate meetings and presentations and special events that include galas, weddings and award ceremonies. Day or night, this is the ideal location with plenty of natural daylight and various light settings to cater to every event.

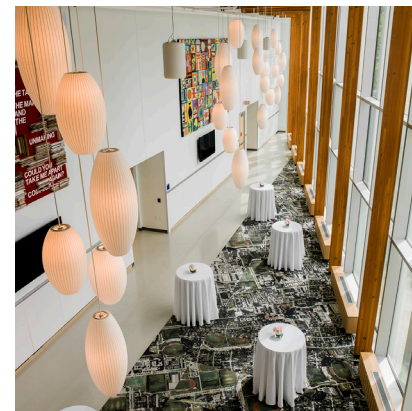

Great Hall Foyer

Build excitement among your guests in this space, before the main event is hosted in the Great Hall. This unique, architecturally-designed triangular pre-function space is west coast design meets open air. Vaulted ceilings and floor-to-ceiling windows create a fresh, inviting networking space for guests. A built-in bar brings this space to life.